

**Positive Post Hole**  
**Crimp Information**

**.65"**  
**[16.5mm]**  
**Dia. Ref**

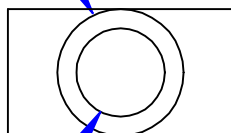

**I.D. Sized For 2/0**  
**[62mm<sup>2</sup>] Stranded Cable**  
**7/8" [22.2mm] Min Depth**

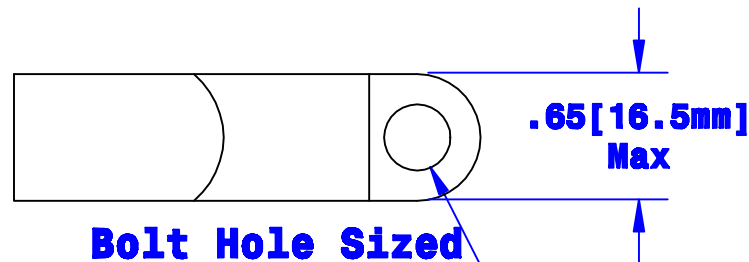
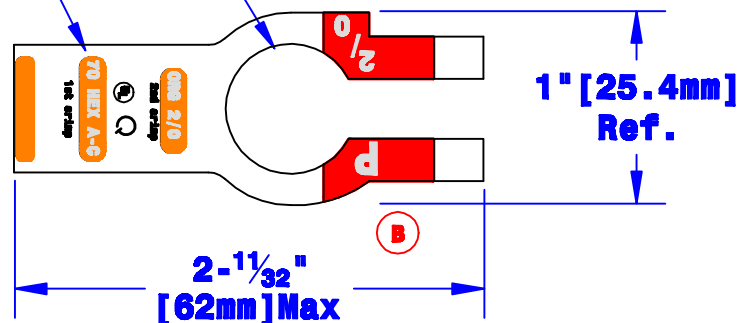

**Bolt Hole Sized**  
**For 5/16" [M8] Bolt**

Property of <b>QUICKCABLE®</b>		TITLE <b>Straight clamp</b>
3700 Quick Drive Franksville, WI 53126 U.S.A. www.quickcable.com		PART # <b>4020P</b>
<b>Confidential and Proprietary Information</b>		
Material & Treatment <b>High Conductivity Copper Alloy Matte Tin Plate</b>	Drawing # <b>4020P-Info</b>	REV <b>B</b>
Sheet 1 of 1		

Rev	Date	ECN#	By	Description	Drawn By	Date	Checked By	Scale
B	02-11-09	1759	JMH	Update print; remove one notch; shorten tange	Paul	3-31-03	Mike E	None
A	5-25-06	1205	JMH	Added color printing to tange	Tolerances, unless otherwise noted Dimensions are reference only			